

# SEE.SENSE® iCON3

## Quick Start Guide

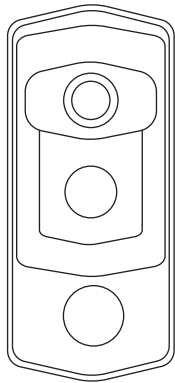

## CHARGE BEFORE USE

Open USB port & insert provided USB-C cable.

First charge 10hrs, normal charge 3hrs.

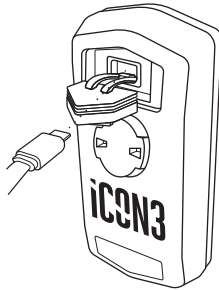

## CHARGE INDICATOR

Appears when light is off and power button is pressed briefly.

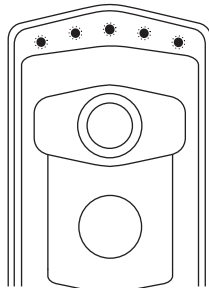

## BUTTON FUNCTIONS

iCON3 has the following button functions:

**Hold - ON**  
Press - High  
Press - Eco  
Press - Constant  
**Hold - OFF**

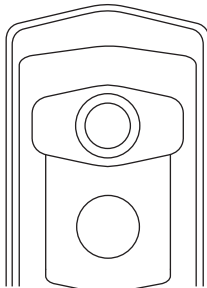

## MOUNT INSTALLATION

Install the mount on the bike, ensuring the strap is tightly secured.

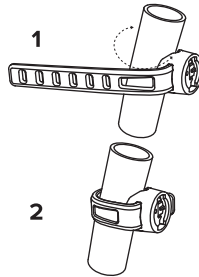

Note: rear mounts are angled, front mounts are not.

## MOUNTING OPTIONS

Position iCON3 on the mount. Twist 90° and 'click' to secure.

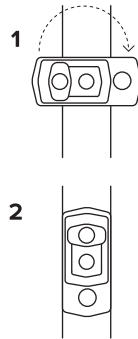

## FLASH MODES



### Super Visibility

Uses different flash patterns every time it reacts to improve your visibility.



### Light Sensing

Monitors ambient light levels and automatically adjusts light output to improve your visibility.



### Get Me Home

1 more hour of runtime when battery levels are very low.

Visit  
[www.seesense.cc](http://www.seesense.cc)  
for more info



## SEE.SENSE MOBILE APP

Search 'See.Sense' in the Apple App Store or Google Play Store & download our app.

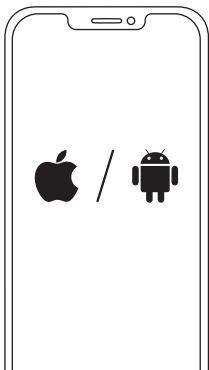

## WHY DOWNLOAD THE APP?

So that you can:



Get low battery notifications



Receive theft alerts



Customise & control your lights



Share insights to make rides better



Send crash alerts to an emergency contact

## MAKING CYCLING BETTER

Opt in via the app to share anonymised ride insights that can help improve conditions for cyclists.

By sharing your ride insights you can help make cycling in your city safer, more convenient and enjoyable.

## HOW IT WORKS

Once you've connected your lights to our app, the technology within the lights can detect the road issues and poor conditions that you face on your journey.

Through See.Sense's app you're then able to share additional insights anonymously with city planners.

## SEE.SENSE ICON3 WARRANTY

Limeforge Ltd provides a warranty for ICON3 for 12 months from the original date of purchase by the original owner (proof of purchase required). This warranty covers parts and workmanship on the LED housing, LED, mounting bracket and electronics but not normal wear and tear, improper use, attempting to access the electronics, modifying the electronics, accidental damage, or damage or failure due to neglect.

If you need to make a claim on the warranty, then return ICON3 with your original receipt to the point of purchase. Do not attempt to disassemble ICON3 or to modify the electronics. Doing so will void warranty.

## IMPORTANT INFORMATION

Charge ICON3 fully before you use it for the first time. To maintain the battery's performance, charge ICON3 fully at least once a month.

ICON3 is IP67 rated under normal use, do not subject it to high pressure water jets or intentionally submerge it in water. In the unlikely event that moisture appears inside ICON3 turn it off and contact our customer service for guidance.

Clean ICON3 using a moistened cloth and mild detergent only. Do not use corrosives, solvents or abrasive materials to clean ICON3. ICON3 uses extremely powerful LEDs which can get hot with use. A thermal protection circuit temporarily reduces brightness if it approaches its thermal limits.

## PRODUCT WARNINGS

See.Sense ICON3 is a very bright light. Do not look directly at the light, or shine it directly at others. Keep it out of reach of children and pets. Staring into the light can cause serious injury. Use ICON3 with care at all times.

Carefully inspect ICON3 before every use. If you find any damage, corrosion, or leaking, turn it off and contact us for guidance. Do not disassemble ICON3. Do not dispose of ICON3 in household waste. Do not incinerate ICON3.

Limeforge Ltd do not warrant that ICON3 complies with all local traffic laws and regulations. Limeforge Ltd accepts no liability for any injuries or other damages arising from the use of this product in any circumstances.

## LIKE OUR PRODUCT? SHOW US!



[seesense.cc](https://www.seesense.cc)



[@seesense\\_cc](https://twitter.com/seesense_cc)



[@seesense\\_cc](https://www.instagram.com/seesense_cc)



[www.seesense.cc](https://www.seesense.cc)